



SPF 700



TECHNICAL DATA

Fluid connections	tri-clamp DN50 ISO 2852
Air connection	3/4" BSP
Max. flow rate	700 lt/min
Max air pressure	8 bar
Max delivery head	80 m
Max suction lift dry	5 m
Max suction lift wet	9,8 m
Max solid passing	8,5 mm
Noise level	78 dB
Max viscosity	50.000 cps
Displacement per stroke	3050 CC ~

Ex II 3/3 G Ex h IIB T4 Gb

Ex II 3 D Ex H IIB T135°C Db X

Displacement per stroke may vary based on suction condition, discharge head, air pressure and fluid type.

**SS AISI 316
ELECTROPOLISHED**



WEIGHT

59 KG

TEMPERATURE

-20°C

+130°C

PERFORMANCE

The curves and performance values refer to pumps with submerged suction and free delivery outlet, with water at 20 °C. These data may vary according to the construction materials and hydraulic conditions.

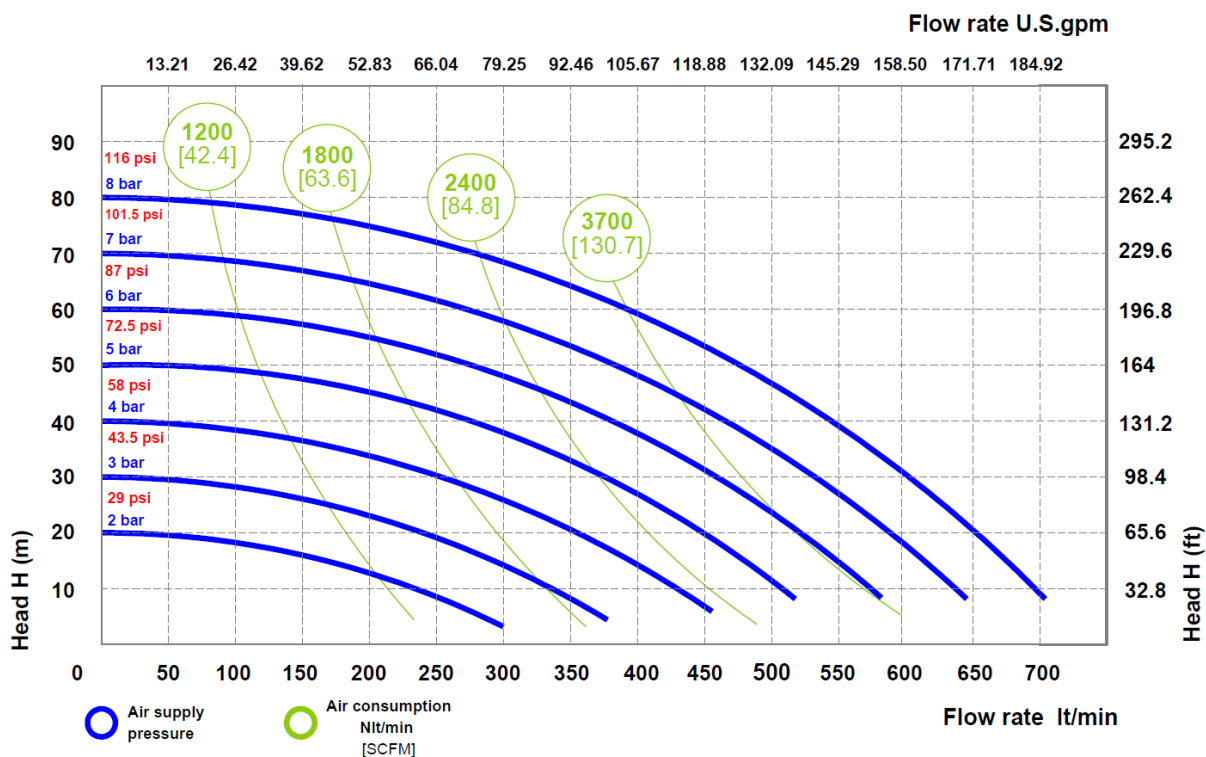

FLUIMAC S.r.l. - Via Breascia, 1 - 21049 - Tradate - VA - ITALY
info@fluimac.com - www.fluimac.com
 tel. +39 0331 866688 - Fax +39 0331 864870
 P.I./VAT 03259160129





SPF 700

COMPOSITION

MODEL	CASING	DIAPHRAGM	BALLS	SEATS	GASKET	CONNECTIONS	ATEX	PORTS
SPF0700	SS = SS ELETCTRO- POLISHED	HT = HYTREL+PTFE MT = SANTOPRENE+PTFE	T = PTFE S = SS	S = SS	T = PTFE	1 = BSP 2 = FLANGED 3 = TRI-CLAMP 6 = DIN	-- ZONE 2	EF = STANDARD

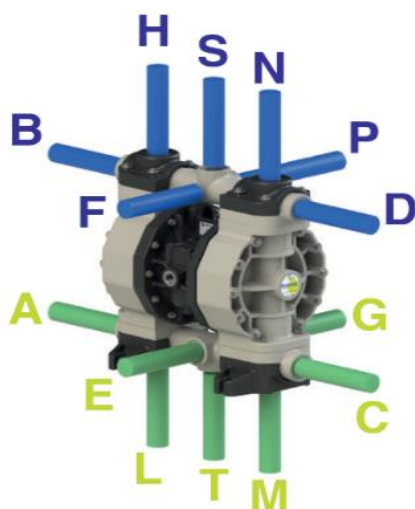

AVAILABLE CONNECTIONS

DELIVERY: F-P

SUCTION: E-G

PACKING DIMENSION

CARTON BOX: 46 x 32 x 59 cm

DIMENSIONS

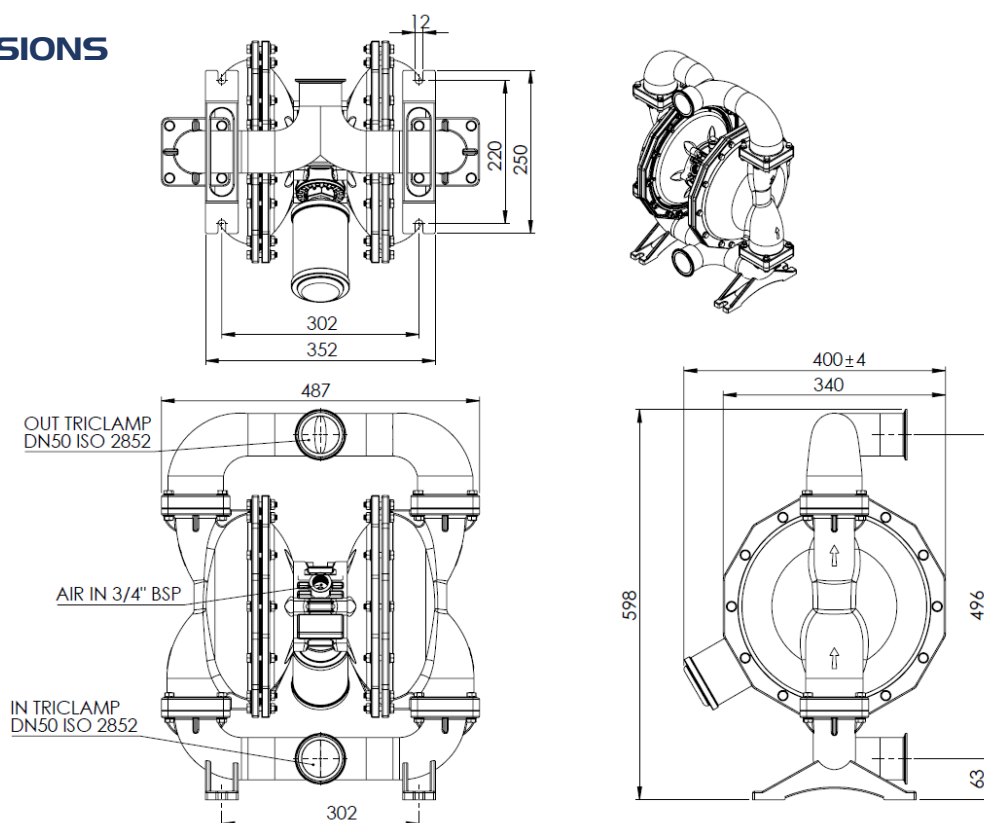

Technical data are approximate and not binding for the manufacturer who reserves the right to change them without notice at any time.



FLUIMAC S.r.l. - Via Brerescia, 1 - 21049 - Tradate - VA - ITALY
info@fluimac.com - www.fluimac.com
 tel. +39 0331 866688 - Fax +39 0331 864870
 P.I./VAT 03259160129

